

無刷電動起子系列

無刷電動起子系列 (標準型)
BRUSHLESS ELECTRIC SCREWDRIVER SERIES

結構尺寸 Structure size

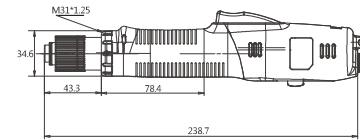

產品參數 Product parameters

Model	ESD(可選)	KD110MLP(S/LOW)	KD216MLP(S/LOW)	KD320MLP
Input Voltage		DC 24V	DC 24V	DC 24V
Nominal Voltage		60W	60W	60W
Torque	kgf.cm	1-10	2-16	3-20
Range	N.m	0.098-0.98	0.195-1.97	0.294-1.96
	lbf.in	0.867-8.68	1.734-13.87	2.601-17.34
Torque Accuracy(%)		±3	±3	±3
Torque Setting		Stepless	Stepless	Stepless
No-Load Speed(rpm)		900-1100/1500	900-1100/1500	900-1100
Trial screw	Machine Screw	2.0-3.0	2.3-3.5	2.6-4.0
Blamper	Machine Screw	1.6-2.6	2.0-3.0	2.6-3.5
Weight (g)		526	526	526
Length (mm)		242	242	242
Available bit size (optional)		Ø4/Ø5/HEX5/6/35		

* Model English letter description: KD : Company product code
M : No carbon motor L : Manual start S : speediness low : low speed
ESD : anti-static z : z shape of screwdriver W : wide range of screwdriver
V : Flavor type BSE : machine appliance P : Downforce start

適用電源控制器 Applicable power controller

model	input voltage (AC)	output voltage (DC)
PRO-3M	100-240	24

產品特點 Features

- Use the high efficiency brushless motor gives unsurpassed durability.
- High precision motor, accurate torque output, can complete a stable screw operation.
- Continuous use of the motor keep the temperature down.
- Suitable for mobile phones, digital products, watches and other micro-electronics industries

輸出扭力曲線表 Output torsion curve table

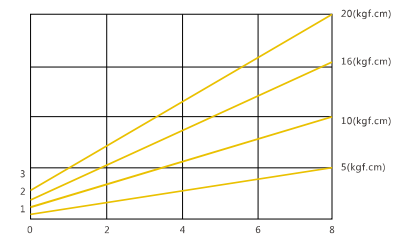

周邊配備 Peripheral equipment



無刷電動起子系列 (標準型) BRUSHLESS ELECTRIC SCREWDRIVER SERIES



無刷電動起子系列 (標準型) BRUSHLESS ELECTRIC SCREWDRIVER SERIES



結構尺寸 Structure size

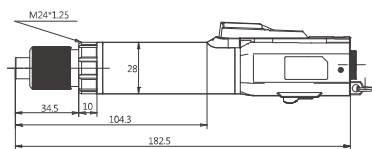

產品參數 Product parameters

Model	ESD(可選)	KD300ML(LOW)	KD500ML(LOW)	KD800ML(LOW)
Input Voltage		DC 24V	DC 24V	DC 24V
Nominal Voltage		60W	60W	60W
Torque	kgf.cm	0.3-3	0.5-5	1-10
Range	N.m	0.029-0.29	0.049-4.9	0.098-9.8
	lbf.in	0.257-2.57	0.44-4.4	0.88-8.8
Torque Accuracy(%)		±3	±3	±3
Torque Setting		Stepless	Stepless	Stepless
No-Load Speed(rpm)		1000/60-800	1000/60-1100	1000/60-1100
Trial screw diameter	Machine Screw	1.0-2.3	1.4-2.6	1.6-3.0
	Trapping Screw	1.0-2.0	1.4-2.3	1.6-2.6
Weight (g)		286		
Length (mm)		182		
Available bit size (top/mill)		Φ4/05/HEX5/6/35		

* Model English letter description: KD : Company product code
M : No carbon motor L : Manual start S : speediness low : low speed
ESD : anti-static z : z shape of screwdriver W : elbow shape of screwdriver
V : Flavor type BSE : machine appliance P : Downforce start

產品特點 Features

- The size of the suction nozzle can be customized according to the screw specifications and operating conditions;
- The carbon-free brush motor is adopted, which has super life and durability.
- High precision motor, accurate torque output, can complete a stable screw operation.
- Continuous use of the motor keep the temperature down.
- Suitable for mobile phones, digital products, watches and other micro-electronics industries

扭力曲線表 Torsion curve table

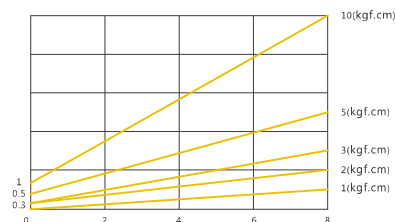

適用電源控制器 Applicable power controller

model	input voltage (AC)	output voltage(DC)
PRO-3M	100-240	24

周邊配備 Peripheral equipment



結構尺寸 Structure size

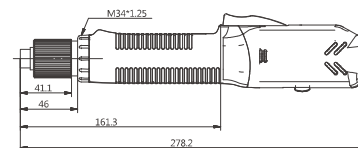

產品特點 Features

- High performance brushless motor, with low interference, low noise, long life, meet the environmental requirements;
- A pulley fan is installed on the top of the motor to prevent the electric starter from overheating due to long-term continuous use, effectively reducing the motor temperature and keeping the grip normal;
- Adopts excellent gold plating switch that is can reduce the maintenance cost;
- All the functional electrical aspects of the electric starter are in the configuration of insert and dial. No soldering iron is needed for subsequent maintenance. Maintenance of this starter does not require professional technology, can effectively improve production efficiency, reduce maintenance costs;
- The high precision and high stability of the adjustable switch power supply enables the speed of the electric starter to be adjusted without segment speed within a certain range, effectively ensuring the flexibility of the product;

扭力曲線表 Torsion curve table

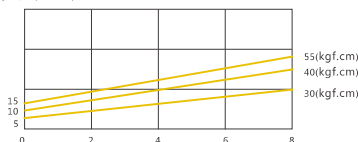

產品參數 Product parameters

Model		KD1030ML(S)	KD1540ML	KD2050ML
Input Voltage		DC 36V	DC 36V	DC 36V
Nominal Voltage		100W	100W	100W
Torque	kgf.cm	10-30	15-40	20-55
Range	N.m	0.98-2.94	1.47-3.92	1.96-5.39
	lbf.in	8.67-26.1	13-34.68	17.34-47.68
Torque Accuracy(%)		±5	±5	±5
Torque Setting		Stepless	Stepless	Stepless
No-Load Speed (rpm)		1000/2000(F)	1000	500
Trial screw diameter	Machine Screw	2.6-4.0	3.0-5.0	3.5-6.0
	Trapping Screw	2.0-3.5	2.5-4.0	3.0-4.5
Weight (g)		850		
Length (mm)		285		
Available bit size (top/mill)		HEX6.35mm(1/4")	HEX6.35mm(1/4")	HEX6.35mm(1/4")

* Model English letter description: KD : Company product code
M : No carbon motor L : Manual start S : speediness low : low speed
ESD : anti-static z : z shape of screwdriver W : elbow shape of screwdriver
V : Flavor type BSE : machine appliance P : Downforce start

適用電源控制器 Applicable power controller

model	input voltage (AC)	output voltage(DC)
PRO-5M	100-240	36V

周邊配備 Peripheral equipment



無刷電動起子系列 (彎頭電動起子)

BRUSHLESS ELECTRIC SCREWDRIVER SERIES



結構尺寸 Structure size

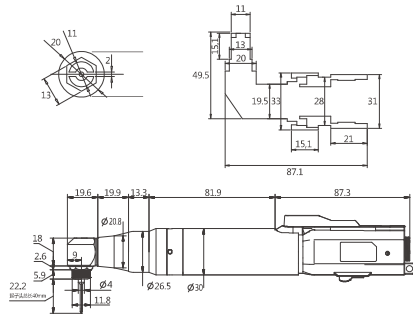

產品特點 Features

- The size of the suction nozzle can be customized according to the screw specifications and operating conditions.
- The carbon-free brush motor is adopted, which has super life and durability.
- High precision motor, accurate torque output, can complete a stable screw operation.
- Continuous use of the motor keep the temperature down.
- Suitable for mobile phones, digital products, watches and other micro-electronics industries

扭力曲線表 Torsion curve table

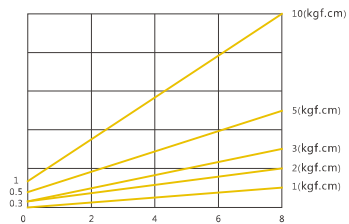

產品參數 Product parameters

Model ESC(可選)	Torque Range		No-Load Speed (rpm)	Tria[screw diameter		Available bit size (optional) (mm)
	kgf.cm	lbf.in		Machine Screw	Tapping Screw	
KD300MLW(LOW)	0.3~3	0.257~2.57	1000 60~1100	1.0~2.3	1.0~2.0	Φ4/HEX6.35
KD500MLW(LOW)	0.5~5	0.44~0.4		1.4~2.6	1.4~2.3	
KD800MLW(LOW)	1~10	0.88~0.8		1.6~3.0	1.6~2.6	
KD110MLW(S/LOW)	1~10	0.867~8.68	900~1100 1500	2.0~3.0	1.6~2.6	Φ4/Φ5/ HEX5/6.35
KD216MLW(S/LOW)	2~16	1.734~13.87		2.3~3.5	2.0~3.0	
KD320MLW	3~20	2.601~17.34		2.6~4.0	2.6~3.5	

* Model English letter description: KD :Company product code
M: No carbon motor L :Manual start S :speediness low: low speed
ESD:anti-static z :z shape of screwdriver W: elbow shape of screwdriver
V: Flavor type BSE: machine appliance P : Downforce start

適用電源控制器 Applicable power controller

model	input voltage (AC)	output voltage (DC)
PRO-3M	100~240	24

周邊配備 Peripheral equipment



無刷電動起子系列 (氣吸式電動起子)

BRUSHLESS ELECTRIC SCREWDRIVER SERIES



結構尺寸 Structure size

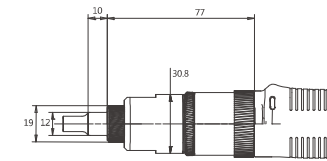

產品特點 Features

- The size of the suction nozzle can be customized according to the screw specifications and operating conditions.
- The carbon-free brush motor is adopted, which has super life and durability.
- High precision motor, accurate torque output, can complete a stable screw operation.
- Continuous use of the motor keep the temperature down.
- Suitable for mobile phones, digital products, watches and other micro-electronics industries

扭力曲線表 Torsion curve table

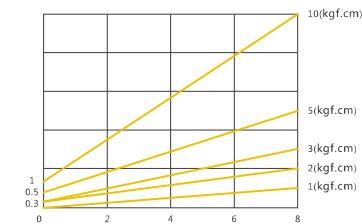

產品參數 Product parameters

Model ESC(可選)	Torque Range		No-Load Speed (rpm)	Tria[screw diameter		Available bit size (optional) (mm)
	kgf.cm	lbf.in		Machine Screw	Tapping Screw	
KD300MLV(LOW)	0.3~3	0.257~2.57	1000 60~1100	1.0~2.3	1.0~2.0	Φ4/HEX6.35
KD500MLV(LOW)	0.5~5	0.44~0.4		1.4~2.6	1.4~2.3	
KD800MLV(LOW)	1~10	0.88~0.8		1.6~3.0	1.6~2.6	
KD110MLV(S/LOW)	1~10	0.867~8.68	900~1100 1500	2.0~3.0	1.6~2.6	Φ4/Φ5/ HEX5/6.35
KD216MLV(S/LOW)	2~16	1.734~13.87		2.3~3.5	2.0~3.0	
KD320MLV	3~20	2.601~17.34		2.6~4.0	2.6~3.5	

* Model English letter description: KD :Company product code
M: No carbon motor L :Manual start S :speediness low: low speed
ESD:anti-static z :z shape of screwdriver W: elbow shape of screwdriver
V: Flavor type BSE: machine appliance P : Downforce start

適用電源控制器 Applicable power controller

model	input voltage	output voltage (DC)
PRO-3M	100~240	24

model input voltage (AC) output voltage (DC)

周邊配備 Peripheral equipment



無刷電動起子系列 (Z型電動起子) BRUSHLESS ELECTRIC SCREWDRIVER SERIES



結構尺寸 Structure size

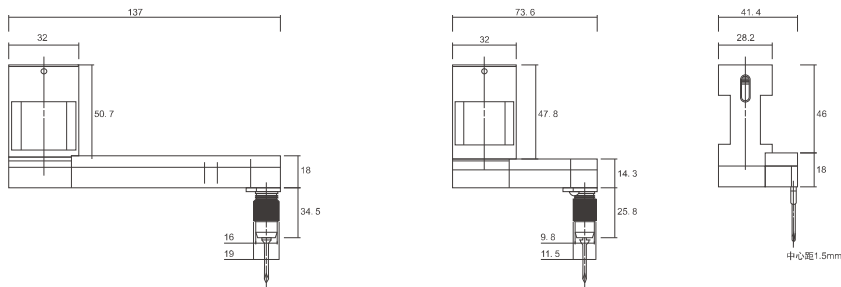

產品特點 Features

- Design in creation, play, beauty, human conception to fit with world trend and be pleased to use, design in ergonomics handle to reduce work fatigue; The role of each functional module is through the LCD panel and the digital tube, in the form of words or numerical display using readable expression, rapidly and exactly in order to facilitate users to understand and use the product; The standard product has four basic functions, including single product count, daily finished quantity statistics, screw floating lock, sliding tooth, and signal input and output;

周邊配備 Peripheral equipment



無刷電動起子系列 (自動機專用) BRUSHLESS ELECTRIC SCREWDRIVER SERIES



結構尺寸 Structure size

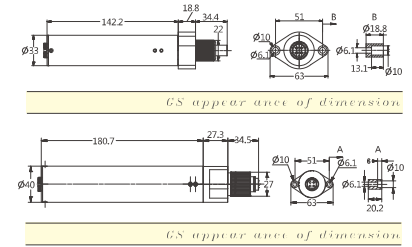

適用電源控制器 Applicable power controller

model	input voltage (AC)	output voltage (DC)
PRO-3M-AUTO	100-240	24V

周邊配備 Peripheral equipment



智能電源 SMART POWER



產品參數 Product parameters

Model ESD(可選)	Torque Range		No-Load Speed (rpm)	Trial screw diameter		Available bit size (optional) (mm)
	kgf.cm	lbf.in		Machine Screw	Tapping Screw	
KD300MLZ(LOW)	0.3-3	0.257-2.57	1000 60-1100	1.0-2.3	1.0-2.0	Φ4/Φ5/ HEX5/HEX6
KD500MLZ(LOW)	0.5-5	0.44-0.4		1.4-2.6	1.4-2.3	
KD800MLZ(LOW)	1-10	0.88-0.8	900-1100 1500	1.6-3.0	1.6-2.6	Φ4/Φ5/ HEX5/6.35
KD110MLZS(LOW)	1-10	0.867-8.68		2.0-3.0	1.6-2.6	
KD216MLZS(LOW)	2-16	1.734-13.87	2.6-4.0	2.3-3.5	2.0-3.0	Φ4/Φ5/ HEX5/6.35
KD320MLZ	3-20	2.601-17.34		2.6-4.0	2.6-3.5	

* Model English letter description: KD: Company product code M: No carbon motor L: Manual start S: speediness low: low speed ESD: anti-static z: z shape of screwdriver w: elbow shape of screwdriver v: Flavor type BSE: machine appliance P: Downforce start

適用電源控制器 Applicable power controller

model	input voltage	output voltage (DC)
PRO-3M	100-240	24

產品參數 Product parameters

Model ESD(可選)	Totque Range		No-Load Speed (rpm)	Trial screw diameter		Available bit size (optional) (mm)
	kgf.cm	lbf.in		Machine Screw	Tapping Screw	
BSE300LOW	0.3-3	0.257-2.57	1000/ 60-1100	1.0-2.3	1.0-2.0	Φ4/Φ5/ HEX5/HEX6
BSE500LOW	0.5-5	0.44-0.4		1.4-2.6	1.4-2.3	
BSE800LOW	1-10	0.88-0.8	900-1100	1.6-3.0	1.6-2.6	Φ4/Φ5/ HEX5/6.35
BSE110'S	1-10	0.867-8.68		2.0-3.0	1.6-2.6	
BSE216'S	2-16	1.734-13.87	2.6-4.0	2.3-3.5	2.0-3.0	Φ4/Φ5/ HEX5/6.35
BSE320	3-20	2.601-17.34		2.6-4.0	2.6-3.5	

* Model English letter description: KD: Company product code M: No carbon motor L: Manual start S: speediness low: low speed ESD: anti-static z: z shape of screwdriver w: elbow shape of screwdriver v: Flavor type BSE: machine appliance P: Downforce start

產品特點 Features

- Design in creation, play, beauty, human conception to fit with world trend and be pleased to use, design in ergonomics handle to reduce work fatigue; The role of each functional module is through the LCD panel and the digital tube, in the form of words or numerical display using readable expression, rapidly and exactly in order to facilitate users to understand and use the product; The standard product has four basic functions, including single product count, daily finished quantity statistics, screw floating lock, sliding tooth, and signal input and output;